

LANDSCAPE PLAN: LEVEL 01 (LOWER GROUND FLOOR)

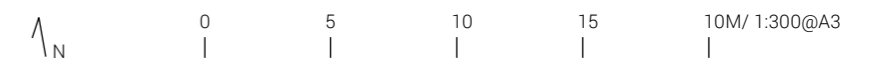

LANDSCAPE PLAN: GROUND FLOOR

**BCC DS
LODGED**
14-SEP-2023
APPLICATION REF
A006361131



- Drawing Key**
- 01 Existing pedestrian footpath along Wynnum Road
 - 02 Drop off driveway crossovers / porte cochère
 - 03 Feature natural stone pedestrian pavement
 - 04 Max 1m high natural stone clad retaining wall terraces
 - 05 End of trip facility entry from Wynnum Road
 - 06 Dry creek bed
 - 07 Mass subtropical feature palm and ground cover planting to undercroft
 - 08 Landscape buffer to adjacent lots to include min. 2 tiers of mixed species to achieve screening and visual softening
 - 09 Amenity planting with low groundcovers and shrubs to provide unobstructed views for passive surveillance
 - 10 Awning over ground floor - refer Architects drawings
 - 11 New road realignment - refer traffic report
 - 12 Basement carpark entry crossover
 - 13 Loading dock crossover
 - 14 Booster
 - 15 Existing bus stop
 - 16 Pavement treatment to terrace (Stone tile or similar)
- Property boundary
- - - Stage 1A boundary



LANDSCAPE PLAN: MEZZANINE FLOOR



LANDSCAPE PLAN: LEVEL 03



Drawing Key

- 01 Planter area to support shrubs, understorey and trailing planting (min. 600mm depth of soil)
- 02 West facade facing planters - to support sun hardy shrubs, understorey and trailing planting (600mm depth of soil)
- Property boundary
- - - Stage 1A boundary

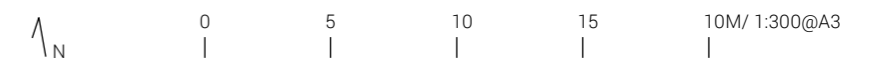

LANDSCAPE PLAN: TYPICAL FLOOR PLATE (LEVEL 04-08)

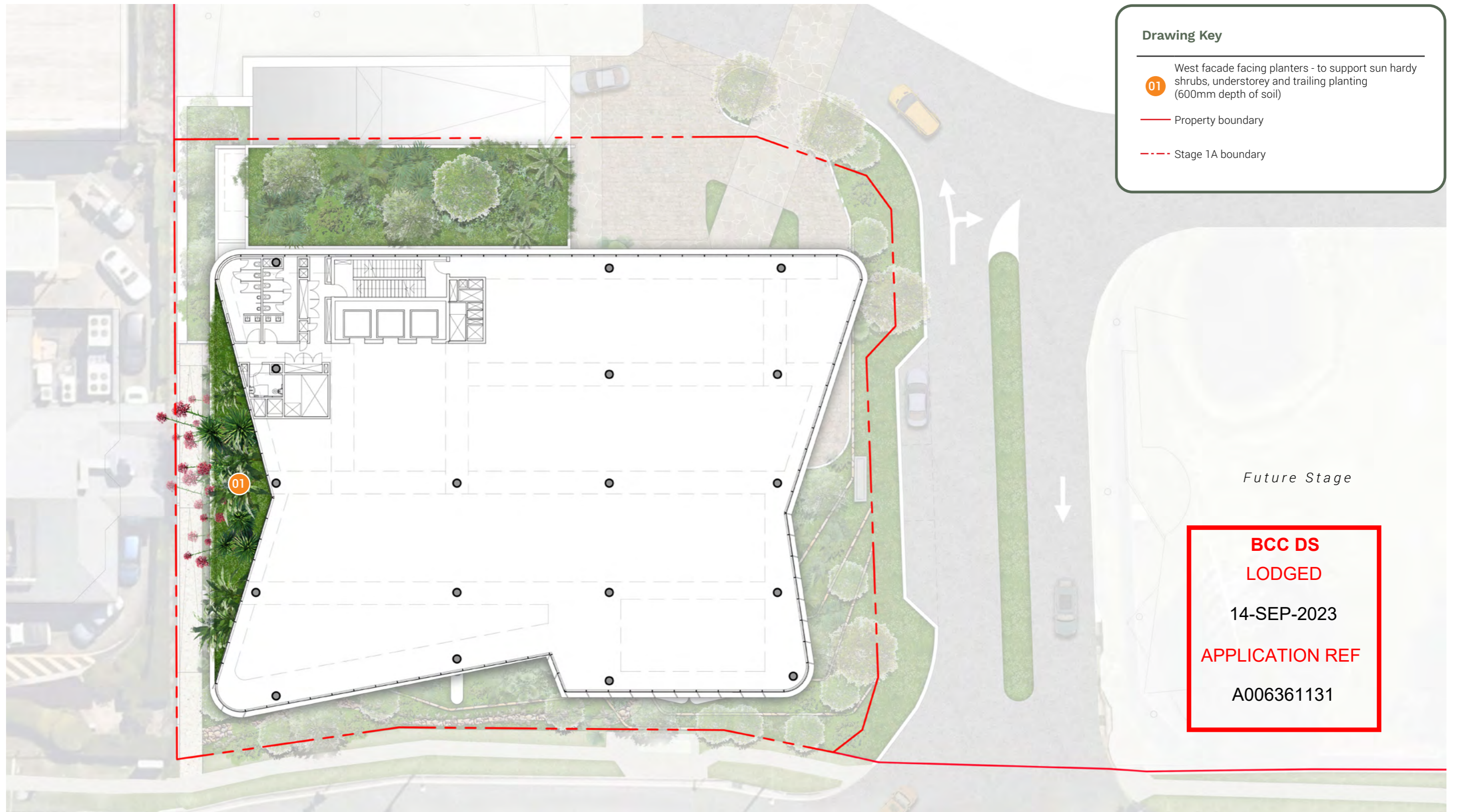

Drawing Key

- 01 West facade facing planters - to support sun hardy shrubs, understorey and trailing planting (600mm depth of soil)
- Property boundary
- - - Stage 1A boundary

BCC DS
LODGED
 14-SEP-2023
APPLICATION REF
 A006361131



LANDSCAPE PLAN: ROOFTOP (LEVEL 09)

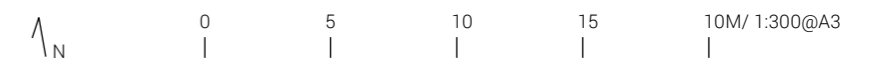

LANDSCAPE PLAN: PLANT LEVEL (LEVEL 10)

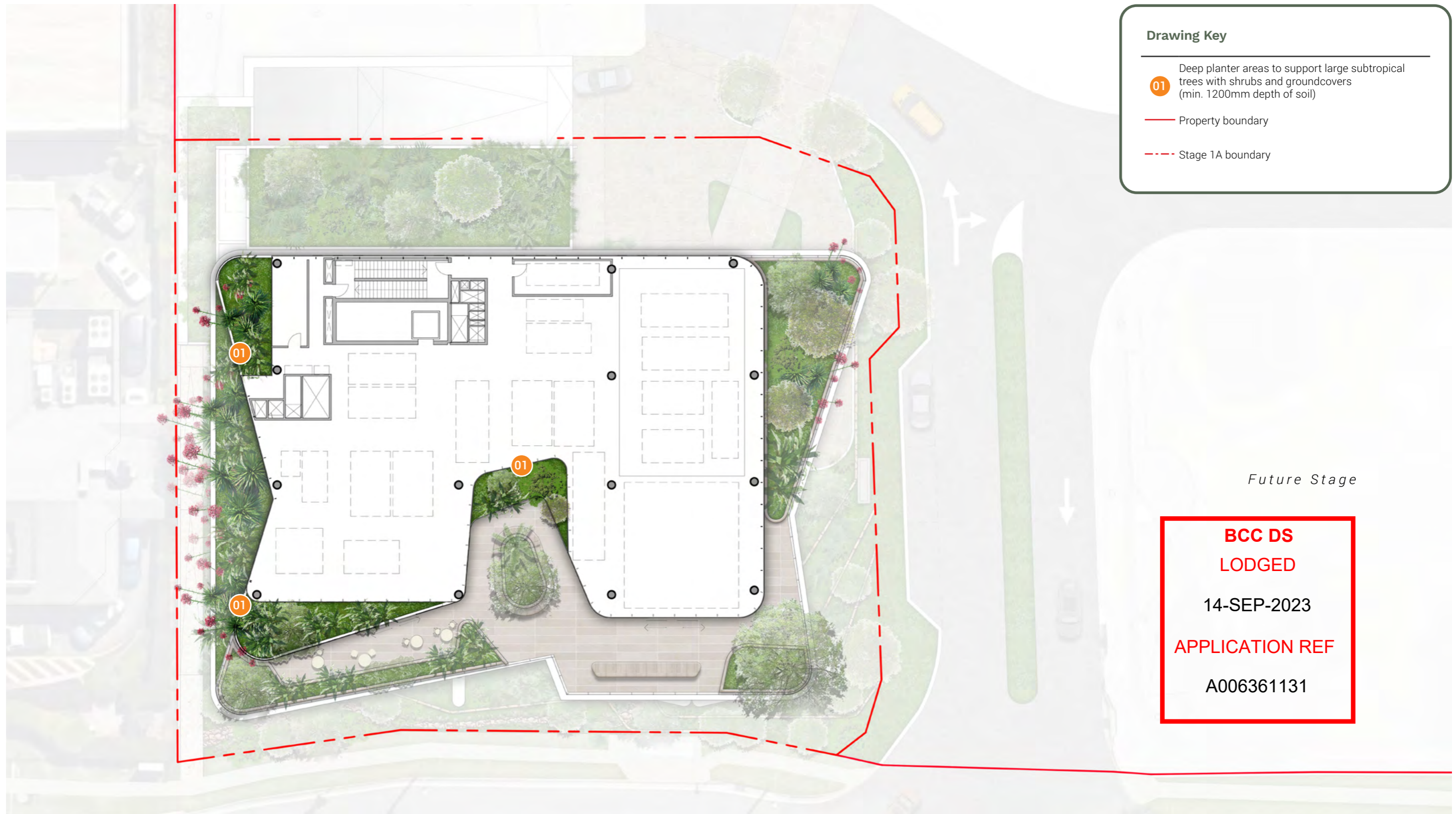

Drawing Key

- 01 Deep planter areas to support large subtropical trees with shrubs and groundcovers (min. 1200mm depth of soil)
- Property boundary
- - - Stage 1A boundary

Future Stage

**BCC DS
LODGED**

14-SEP-2023

APPLICATION REF

A006361131

